

# TRACK CATALOGUE

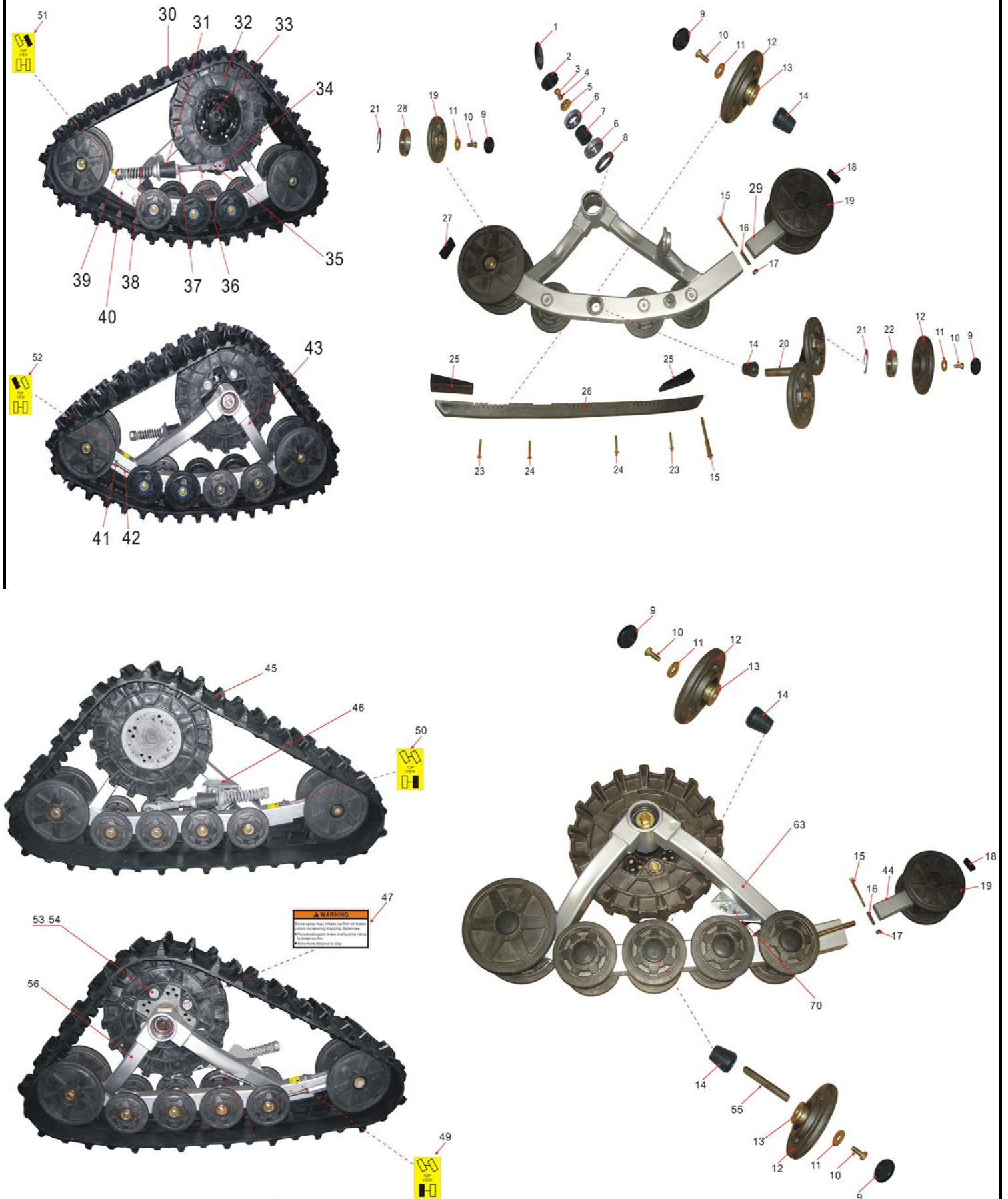

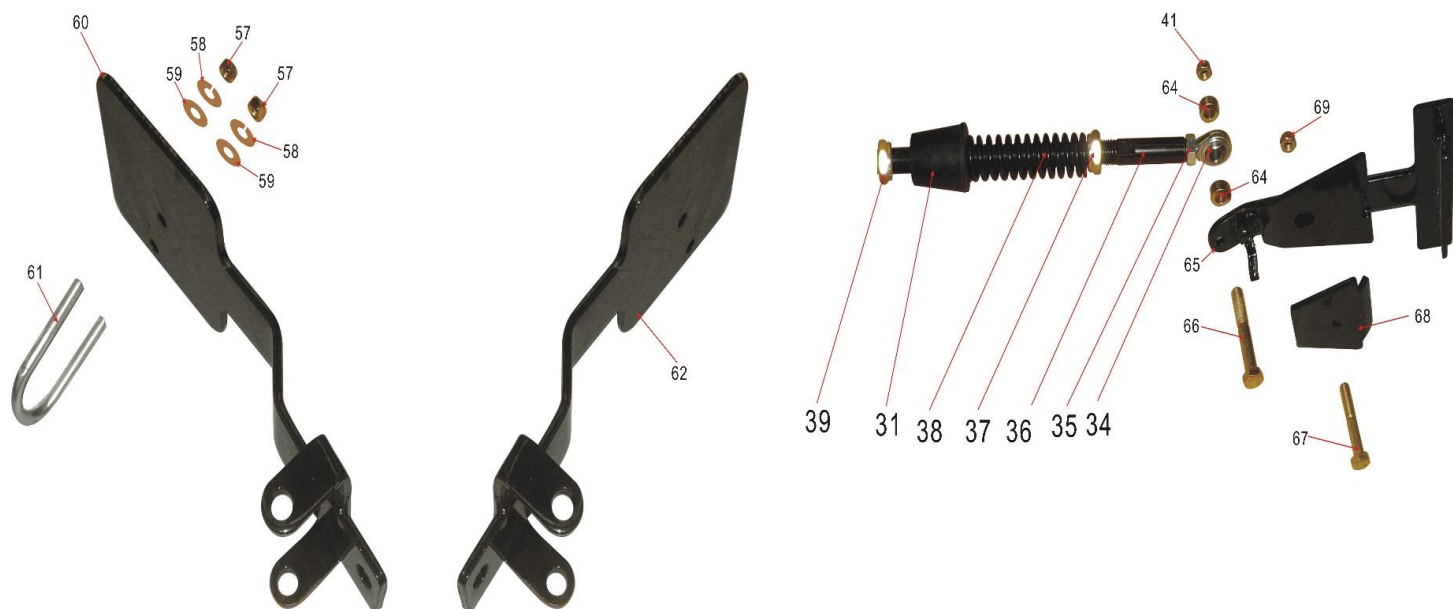

Item	Part no	Код 1C	Description
1	41358-055-0000	LU032504	Crystal lable rubber, Driving wheel dust cover
2	41357-055-0000	LU032479	Dust cover, Driving wheel
3	5783-14-30	LU032503	Hexagon bolt M14*30
4	93-14-00	LU028804	Cushion Φ14
5	41356-055-0000	LU032505	insert gasket,Drive axle
6	276-6007RS	LU032506	Fully sealed bearing 6007RS (without oil)
7	41323-055-0000	LU032507	bush, Driving wheel bearing
8	41354-055-0000	LU032508	Oil seal Φ50*Φ62*10, Drive axle
9	41315-055-0000	LU032509	Dust cover, Supporting wheel
10	25.10.5783	LU019790	Hexagon bolt M10*25
11	41314-055-0000	LU019582	Large gasket Φ11*Φ32*3
12	41316-055-0000	LU032500	Supporting Wheel A (Smaller One)
13	41333-055-0000	LU032501	insert bush, Smaller supporting wheel
14	41334-055-0000	LU032502	Tapered rubber bush
15	41342-055-0000	LU032510	Strengthen cup head square neck bolt, Type A M8*100
16	41343-055-0000	LU032529	Long bush
17	889.1-8-00	LU032542	Non-metal hexagon locknut M8
18	41341-055-0000	LU032530	Dust cover, Bracket end (Smaller end)
19	41313-055-0000	LU032531	Supporting Wheel (Bigger One)
20	41331-055-0000	LU032532	Swing support
21	893.2-56.2-3.2	LU032486	Flexible Hole Collar, Type B Φ56.2*Φ3*2
22	276-6205-2RS/P6	LU029817	Fully sealed bearing 6205-2RS/P6 (blue cover)
23	41320-055-0000	LU032539	Hexagon socket countersunk head screws M6*40
24	41321-055-0000	LU032540	Hexagon socket countersunk head screws M6*12 (short)
25	41319-055-0000	LU032533	Block, Oriented pad
26	41318-055-0000	LU032537	Oriented pad
27	41322-055-0000	LU032538	Dust cover, Bracket end (Bigger end)
28	276-6205-2RS1/P63	LU029817	Fully sealed bearing 6205-2RS1/P63 (black cover)
29	41344-055-0000	LU032528	Front adjustment bracket
30	41370-055-0000	LU032485	Rubber Track (Front)
31	41367-055-0000	LU032535	Rubber cover, adjustment Rod

32	41351-055-0000	LU032534	Driving wheel
33	41353-055-0000	LU032536	Driving wheel mounting seat
34	41363-055-0000	LU032546	Ball joint,Connecting Rod
35	41-14-00	LN001379	Hexagon nut M14
36	41362-055-0000	LU032545	Adjustment Rod
37	6172.2- 20-00	LU032543	Non-metal hexagon flimsy locknut M20
38	41366-055-0000	LU032547	Spring, Adjustment Rod
39	889.1-20-00	LU032544	Non-metal hexagon locknut M20
40	41411-055-0000	LU032482	Front right support
41	889.1-12-00	LU032548	Non-metal hexagon locknut M12
42	41368-055-0000	LU032617	Adjustment rod, support
43	41311-055-0000	LU032483	Front left support
44	41544-055-0000	LU032527	Rear adjustment support
45	41570-055-0000	LU032484	Rubber Track (Rear)
46	41562-055-0000	LU032522	Adjustment rod mounting seat
47	41324-055-0000	LU032521	Note sticker, Connector
49	41526-055-0000	LU032519	Installation instruction sticker (Rear left)
50	41626-055-0000	LU032518	Installation instruction sticker (Rear right)
51	41426-055-0000	LU032517	Installation instruction sticker (Front right)
52	41326-055-0000	LU032516	Installation instruction sticker (Front left)
53	30.10.5783	LU032515	Hexagon bolt M10*30
54	41355-055-0000	LU032514	Flat gasket Φ11*Φ26*2.5
55	41512-055-0000	LU032513	insert axle,smaller supporting wheel
56	41511-055-0000	LU032481	Support (Rear left)
57	6170-8-00	LU013987	Hexagon nut M8
58	93-8-00	LU016401	Cushion Φ8
59	96-8-00	LU022257	Flat washer Φ8
60	41561-058-0000	LU032493	Connecting plate (Rear left)
61	41564-058-0000	LU032492	U-HOOP
62	41661-058-0000	LU032489	Connecting plate (Rear right)
63	41611-055-0000	LU032480	Support (Rear right )
64	41364-055-0000	LU032488	Connecting plate bush
65	41361-058-0000	LU032487	Front connecting plate
66	41565-055-0000	LU032499	Hexagon headed bolt M12*70(Lg=48)
67	5783-10-55	LU032498	Hexagon bolt M10*55(Lg26)
68	41365-058-0000	LU032497	Front connectiong press plate
69	889.1-10-00	LU032496	Non-metal hexagon locknut M10
70	41563-055-0000	LU032495	Fixed block for nut